

INSTALLATION

1. INSTALL FUEL INJECTOR

- Install a new insulator to the fuel injector.
- Apply a light coat of spindle oil or gasoline to a new O-ring and install it to the fuel injector.

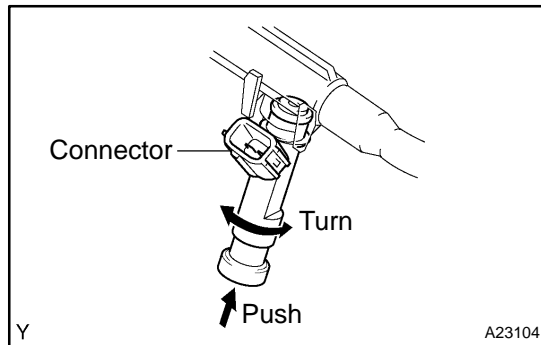

- While turning the fuel injector to the left and right, install it to the fuel delivery pipe.
- Position the fuel injector connector facing out from the fuel delivery pipe.
- Apply the above procedures to the other fuel injectors.

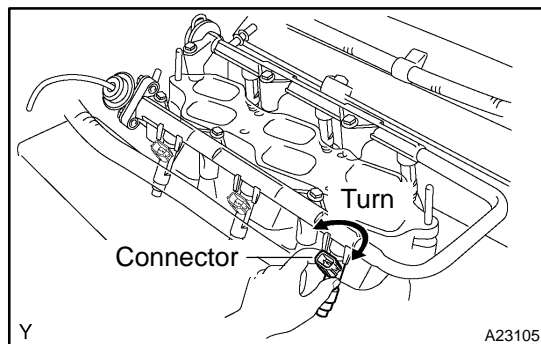

2. INSTALL FUEL DELIVERY PIPE

- Place the fuel delivery pipe together with the 6 fuel injectors on the intake manifold.
- Temporarily install the 6 bolts which are used to hold the fuel delivery pipe to the intake manifold.
- Check that the fuel injectors rotate smoothly.

HINT:

If the fuel injectors do not rotate smoothly, the probable cause is incorrect installation of O-rings. Replace the O-ring of the injector that does not rotate smoothly.

- Position the fuel injector connector facing out from the fuel delivery pipe.
- Tighten the 6 bolts which are used to hold the fuel delivery pipe to the intake manifold.

Torque: 15 N·m (153 kgf·cm, 11 ft·lbf)

- Connect the 6 fuel injector connectors.

3. CONNECT FUEL PIPE NO.2

- Push in the tube connector to the pipe, then tube connector makes a "click" sound.

NOTICE:

- Check if there is any damage or foreign objects on the connected part of the fuel pipe.
- After connecting, check if the pipe and connector are securely connected by pulling them.

- Install the fuel pipe clamp.

4. CONNECT FUEL PIPE NO.1

- (a) Push in the tube connector to the pipe, then tube connector makes a "click" sound.

NOTICE:

- **Check if there is any damage or foreign objects on the connected part of the fuel pipe.**
- **After connecting, check if the pipe and connector are securely connected by pulling them.**

- (b) Install the fuel pipe clamp.

5. INSTALL INTAKE AIR SURGE TANK

(See page [EM-62](#))

6. INSTALL AIR CLEANER (See page [EM-89](#))

7. INSTALL V-BANK COVER

8. ADD ENGINE COOLANT

9. CHECK FOR FUEL LEAKS